

# M·B·C

MARCH BUSINESS CENTER

277,243 sq. ft.  
INDUSTRIAL DISTRIBUTION FACILITY



16415 COSMOS STREET, MORENO VALLEY, CA

## PROJECT FEATURES

- 277,243 SF Located on 11.74 Net Acres
- 32' Minimum Clear Height
- 4,000 SF Office Area
- 185' Secured Concrete Truck Court
- 40 Dock High Doors (9'x10')
- 10 Dock Doors w/ 35,000 lb. Kelley Load Levelers
- 2 Grade Level Doors (12'x14')
- 47 Trailer Parking Stalls
- 131 Car Parking
- 52' x 50' Typical Column Spacing
- LED Warehouse Lighting
- 2.5% Skylights
- ESFR Sprinkler System (K-17)
- Easy Access to I-215 Freeway via Cactus Ave & Harley Knox Blvd
- Coporate Neighbors include:
  - Procter & Gamble, Lowe's, Amazon, Home Depot, Ross, Walgreens, Deckers, Aldi Sales

Another Quality Project by:

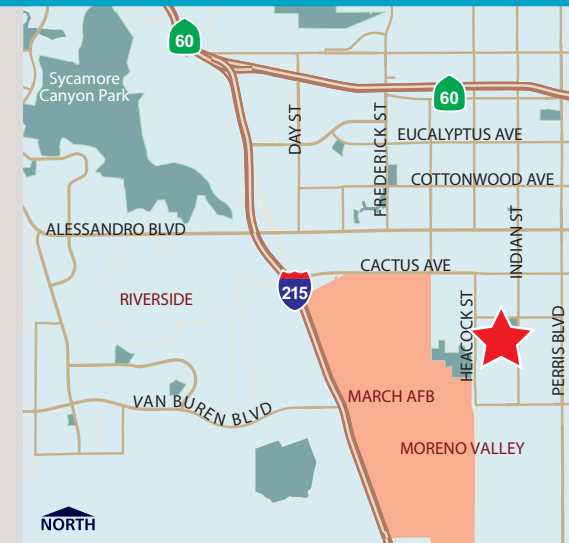

**Chuck Belden, SIOR**  
+1 909 942 4640  
chuck.belden@cushwake.com  
Lic. No: 00844840

**Kyle Kehner**  
+1 909 942 4645  
kyle.kehner@cushwake.com  
Lic. No: 01239566

**Tim Pimentel**  
+1 909 942 4647  
tim.pimentel@cushwake.com  
Lic. No: 01421452



# M·B·C

MARCH BUSINESS CENTER

16415 COSMOS STREET, MORENO VALLEY, CA

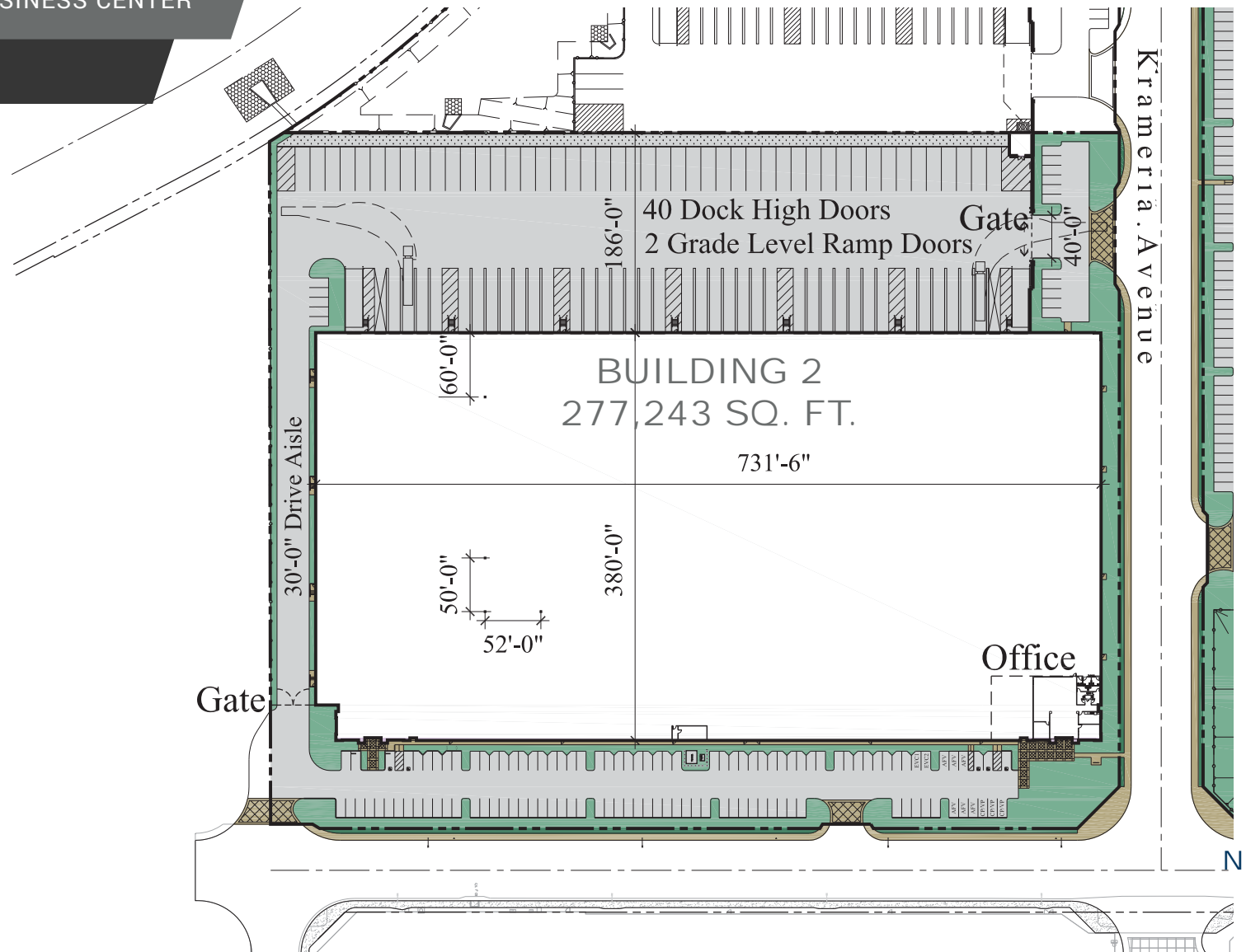

No warranty or representation, express or implied, is made as to the accuracy of the information contained herein, and same is submitted subject to errors, omissions, change of price, rental or other conditions, withdrawal without notice, and to any specific listing conditions, imposed by our principals. This listing shall not be deemed an offer to lease, sublease or sell such property and, in the event of any transaction for such property, no commission shall be earned by or payable to any cooperating broker except if otherwise provided pursuant to the express terms, rate and conditions of C&W's arrangement with its principal, if, as and when such commission (if any) is actually received from such principal.

**Chuck Belden, SIOR**  
+1 909 942 4640  
chuck.belden@cushwake.com  
Lic. No: 00844840

**Kyle Kehner**  
+1 909 942 4645  
kyle.kehner@cushwake.com  
Lic. No: 01239566

**Tim Pimentel**  
+1 909 942 4647  
tim.pimentel@cushwake.com  
Lic. No: 01421452

 **CUSHMAN & WAKEFIELD**